

WIX WS10138 Fuel Filters



WS10138 Kit



WIX Filters now offers easy mount fuel filters for diesel and bio-diesel engines up to 140 hp. Once the mounting bracket has been installed, the one piece filter construction requires no tools for servicing. The filter's nylon body will not rust and the clear bowl allows for easy water level detection. Water coalescing media offers effective water removing capability as well as solid contaminant filtration (2 microns). The WIX WS10138 ships as a kit containing the mounting bracket, (2) 3/8 in. quick connect fitting for use on 5/16 ID hose, a priming coupling and a filter unit (WS10139).

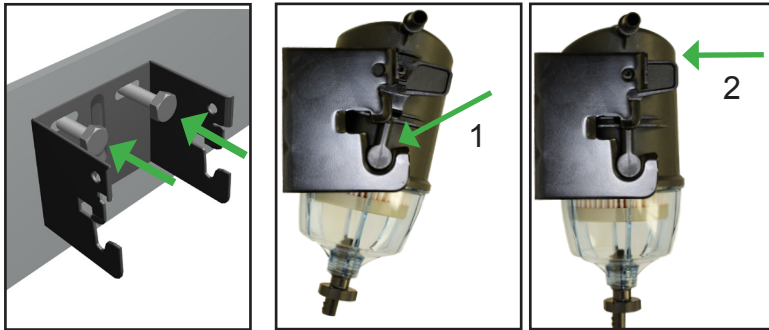

For all engines up to 140 hp
Diesel, Bio-Diesel

- Oil/Gas/Mining Applications
- Construction Applications
- Agricultural Applications

SPECIFICATIONS

Maximum Flow Rate	26 gph (100 lph)
Horsepower Range	up to 140 hp
Filter Media	Solid Contaminate (2 microns) Water Coalescing
Height	7.8" (198 mm)
Width	3.8" (97 mm) at bracket
Depth	4.1" (104 mm)
Water Sump Capacity	3.4 oz. (100 ml)
Body Material	Nylon 6 plastic
Bracket Material	Coated Steel
Port Size	3/8" (9.5 mm)
Quick-Connect	3/8" (9.5 mm) (per SAE J2044)
Rated Pressure	50 PSI (3.5 bar)
Water Removal	99%

Priming Process

Connect filters with supplied coupling

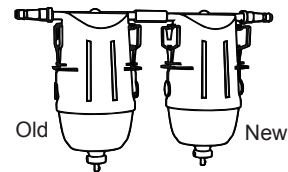

Flip old filter and open drain to prime the new filter

